

**ELEVATION**

WOODEN BATTENS  
0.05x0.025/HALF ROUND BAMBU

<65x65x6  
M.S.PIPE  $\phi$ 50

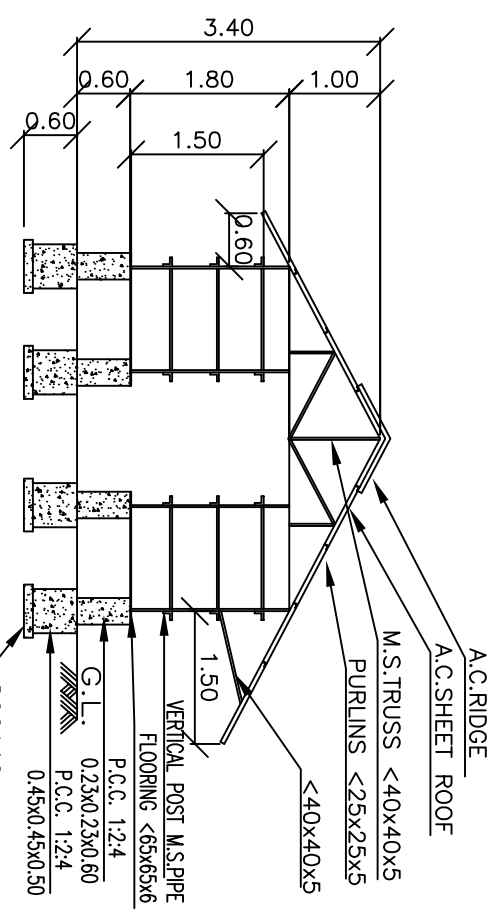

**SECTION 'X-X'**

A.C. RIDGE  
A.C. SHEET ROOF

M.S. TRUSS <40x40x5  
PURLINS <25x25x5

<40x40x5

VERTICAL POST M.S.PIPE  
FLOORING <65x65x6

P.C.C. 1:2:4  
0.23x0.23x0.60

P.C.C. 1:2:4  
0.45x0.45x0.50

G.L.

P.C.C. 1:4:8  
0.60x0.60x0.10

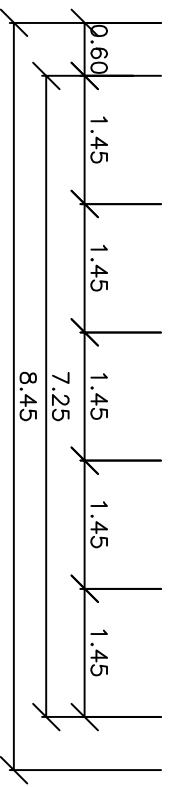
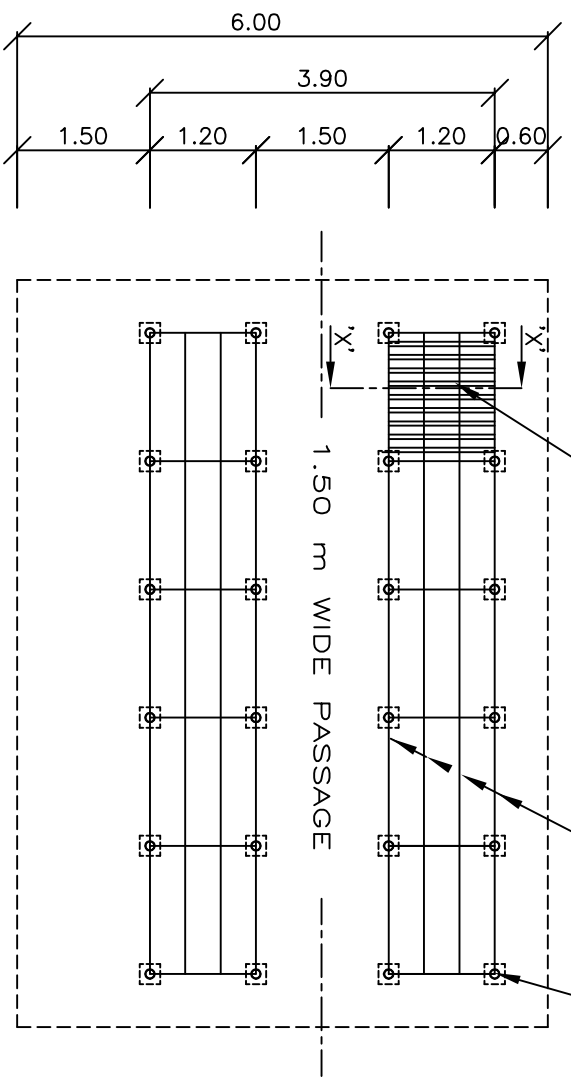

**PLAN**

**ONION STORAGE STRUCTURE OF 15 M.T. CAPACITY**

NOTE: 1) ALL DIMENSIONS ARE IN METERS EXCEPT MENTIONED.  
2) ANGLE SIZES ARE IN MM  
3) DRAWINGS ARE NOT BE SCALED.

**PLAN OF PROPOSED ONION STORAGE SHED OF 15 M.T.**  
[ DOUBLE ROW TYPICAL PLAN ]

DRN:— <i>Unit Sanganal</i>	SCALE :— N.T.S
CHD :— MANAGER (CIVIL-2)	DATE :— 25/04/2006



*Maharashtra State  
Agricultural Marketing Board*

Plot No.R-7, Market Yard, Gultekadi, Pune-411037  
Tel No.: 020-24261190 Fax No.: 020-24272095  
E-mail: civil@msamb.com, Web: www.msamb.com

Drg.No.  
KC 03  
RM/DT/15/07/2008